

MK-BN44i-YAM

Rebuild kit for one Super BN44i or BN46i carburetor

FITS ONLY: Yamaha Watercraft engine with Power Valve System
(Type 60T, 66E, 66V, 67X, 68N)

Item #	Part #	Description
1.	BN46I/13	Gasket, Pump
2.	BN46I/14	Diaphragm, Pump (Clear)
3.	616-92014	O-Ring
4.	999-815-071	Check valve (2 pcs)
5.	BN34/125	Grommet (2 pcs)
6.	BN46I/34	Diaphragm, Damper
7.	BN46I/15	Diaphragm, Damper (Clear)
8.	6164I2015	O-Ring
9.	BN44/146	Filter, Fuel
10.	B21/h 56	O-Ring, Hi speed
11.	B21/156	O-Ring, Low speed
12.	KV/10	O-Ring, Needle valve
13.	BN34/423	Gasket, Valve body
14.	BN34/107	Check valve (Clear)
15.	VM30/37	Pin, Arm
16.	730-03027	Spring, Arm 115 gram
17.	BN38/534	Arm (Stainless)
18.	BN44/145	Diaphragm assy., Main

NOTE: Rebuild Kit contains parts 1 through 18 and 39

BN44I/BN46I Replacement Parts

19.	BN34/120-35	Screw w/ 2 washers (4 pcs)**
20.	BN46I/35	Cover, Pump
21.	BN46I/49	Body Assy., Pump
22.	BN38I/40	Stop screw, Idle
23.	BN38/39	Washer, Aluminum (3 pcs)
24.	BN38/344	Spring (2 pcs)
25.	BN44/118	Cap, Hi speed adjuster
26.	604-25017	Adjuster, Hi speed
27.	BN38/172	Washer, Aluminum (2 pcs)
28.	BN38/343	Spring, Low speed
29.	BN38/477	Adjuster, Low speed
30.	N102.221-size	Jet, Hi speed
31.	N100.606-size	Jet, Low speed
32.	BV15/121-05-GG	Screw
33.	BN34/108-GG	Plate, Valve
34.	BN44/165	Valve body assy.
35.	C5-0414-G	Screw (2 pcs)
36.	786-35018-size	Needle valve assy.
37.	BN34/117-GG	Plate, Needle valve retainer
38.	CW2=0307-G	Screw w/ washer
39.	C6=0308-G	Screw
40.	BN44/147	Cover (Stainless, unpainted)
41.	C2S=0514	Screw (4 pcs)**
42.	BN40I/22	Diaphragm, Acclr. pump

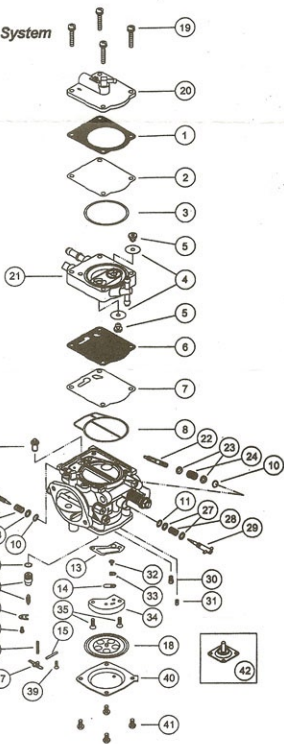

**Tightening Torque:

Part No. 19: 4.5 N·m (45 kg·cm)

Part No. 42: 3.5 N·m (35 kg·cm)

NOTE: DO NOT use gasket sealant during assembly